

ATTENTION PLEASE CHECK THE ULTRAFLO WEBSITE AT www.ultraflovalve.com TO ENSURE YOU HAVE THE MOST RECENT COPY OF THIS DOCUMENT

NOTES:

1. ALL DIMENSIONS IN INCHES
2. VALVE WITH FULLCUT DISC CARRIES A PRESSURE RATING OF 150 P.S.I.
3. VALVE O.D. AND FLANGE BOLT CIRCLE MUST SHARE COMMON CENTER LINE. VALVE DESIGN TO BE PLACED BETWEEN ANSI 125 OR 150 LB FLANGES (NOT FOR USE WITH ASA 250 OR 300 LB FLANGES).
4. TEFLON LINED VALVES ARE UNSUITABLE FOR SLIP-ON FLANGES
5. Q DIMENSION: IS THE MINIMUM FLANGE OR PIPE I.D. TOLERABLE FOR PROTECTION OF DISC SEALING EDGE WHILE OPERATING CENTERED BETWEEN FLANGES.
6. THE 8", 10" AND 12" HAVE STANDARD TOP PLATES.

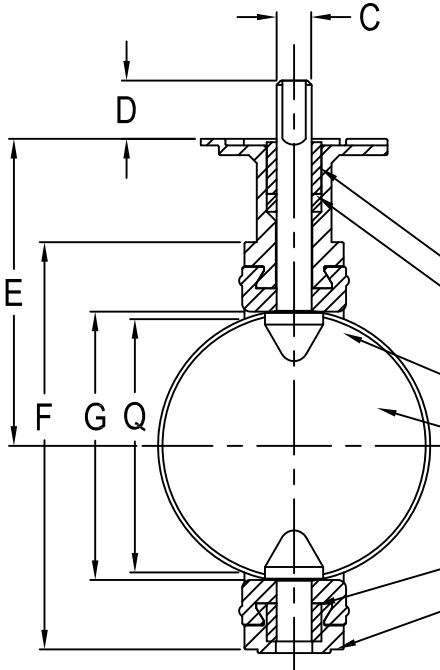
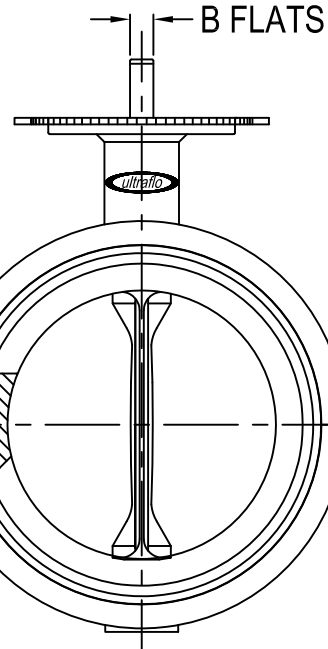
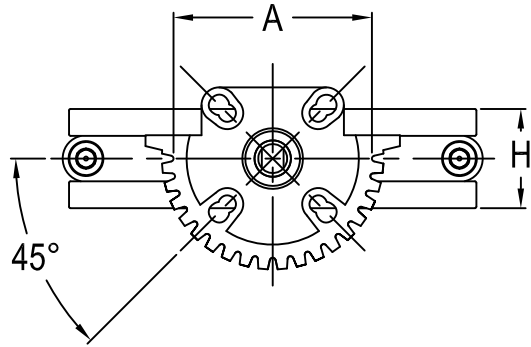

BODY SCREWS AND NUTS 2

NAME	NUMBER REQUIRED	MATERIAL	PART NUMBER
UPPER BUSHING	1		
PACKING	1		
SEAT	1		
DISC-STEM	1		
LOWER BUSHING	1		
BODY	1		

VALVE DIMENSIONS

SIZE	VALVE DIMENSIONS										TOP PLATE DRILLING					
	A	B	C	D	E	F	G	H	Q	WT. LBS	ISO DRILLING			STD DRILLING		
											B. CIRCLE	HOLES	HOLE DIA.	B. CIRCLE	HOLES	HOLE DIA.
2	4.000	.375	.563	1.250	4.063	4.125	2.000	1.625	1.313	4.000	2.760	4	.375	3.250	4	.438
3	4.000	.375	.563	1.250	5.000	5.375	3.000	1.750	2.563	6.000	2.760	4	.375	3.250	4	.438
4	4.000	.438	.625	1.250	6.000	6.875	4.000	2.000	3.563	9.000	2.760	4	.375	3.250	4	.438
6	4.000	.500	.750	1.250	6.625	8.750	5.750	2.125	5.438	14.000	2.760	4	.375	3.250	4	.438
8	6.000	.625	.875	1.250	8.313	11.000	7.750	2.500	7.438	25.000	4.020	4	.438	5.000	4	.562
10	6.000	—	1.125	2.000	9.125	13.375	9.750	2.500	9.531	40.000	4.020	4	.438	5.000	4	.562
12	6.000	—	1.125	2.000	10.625	16.125	11.750	3.000	11.500	63.000	4.020	4	.438	5.000	4	.562

10" AND 12" C SIZE STEM CONNECTION DIAMETER WITH 1/4" X 1/4" KEYWAY.

ZONE	REV	DATE	BY	APP'D	ECN	DESCRIPTION
A1	2	05/06/10	DSS	CJH	374	UPDATED TITLEBLOCK
E4	1	07/06/09	CJH	CJH		ADDED TEFLON NOTE

Ultraflo Corporation
A Subsidiary of Bray International, Inc.

#8 Trautman Ind. Dr.
Ste. Genevieve, Mo.
63670 800-950-1762

DRAWN BY	NAME	DATE
CHECKED	TJM	05/25/98
	TJM	05/25/98

2"-12" 399 SERIES VALVE

PART: 399 VALVE INVESTMENT CAST WAFER BODY, ONE-PIECE DISC-STEM, PTFE, EPDM, NITRILE, VITON, BUNA SEAT

ECN: DWG: 399/392-3