

ASME Class 300 Flanged  
Cast Steel Gate Valve  
**Sharpe® Series 35314**



**Design Features**

- Outside screw and yoke
- Bolted bonnet
- Flexible wedge, fully guided
- Integrated seats
- Rising stem and non-rising hand-wheel
- Available with gear operator
- Trim 8

**Applicable Standards**

- Gate valves: API 600
- Steel valves: ANSI B16.34
- Face to face: ANSI B16.10
- End flanges: ANSI B16.5
- Butt-weld ends: ANSI B16.25
- Inspection and test: API 598
- Nace: MR-0175

**Technical Information**

Temperature °F	Working Pressure psi
-20 to 100	740
200	680
300	655
400	635
500	605
600	570
650	550
700	530
750	505
800	410
850	320
900	230
950	135
1000	85



asc-es.com

Building connections that last™

ASME Class 300 Flanged  
Cast Steel Gate Valve  
Sharpe® Series 35314

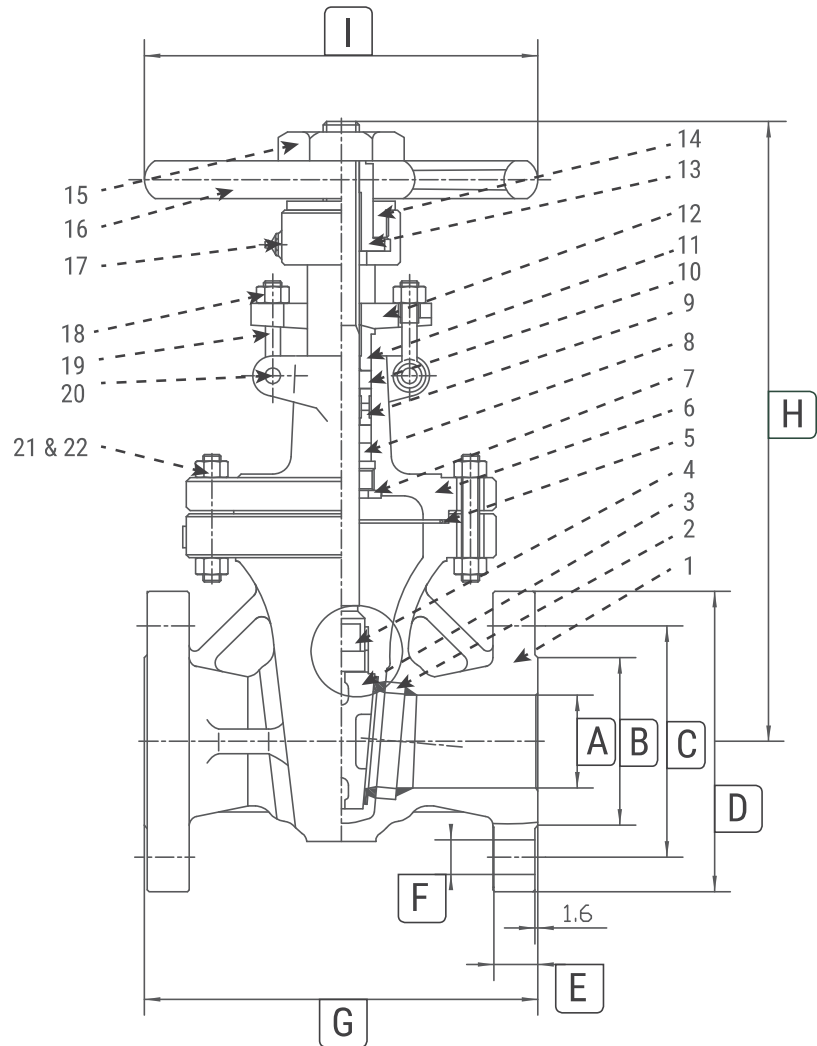
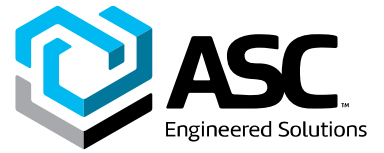

Parts & Materials (Sizes 2" – 10")

No.	Part Name	Material
1	Body	Carbon Steel ASTM A216 - WCB
2	Seat	A105 & STL.6
3	Wedge	A216 WCB & ER410
4	Stem	A182 - F6a
5	Gasket	304 Stainless Steel & Graphite
6	Bonnet	Carbon Steel ASTM A216 - WCB
7	Back Seat	410 Stainless Steel
8	Gland Packing	304 Stainless Steel & Graphite
9	Distance Ring	410 Stainless Steel
10	Gland Packing	Flexible Graphite
11	Gland	410 Stainless Steel
12	Gland Flange	Carbon Steel ASTM A216 - WCB
13	Stem Nut	A439-D2
14	Gland Nut	Carbon Steel
15	Lock Nut	Carbon Steel
16	Hand-wheel	Ductile Iron
17	Grease Nipple	Carbon Steel
18	Eye Nut	B7 Steel A193
19	Eye Bolt	2H Steel A194
20	Pin	Carbon Steel
21	Bolt	B7 Steel A193
22	Nut	2H Steel A194

Dimensions (Inches)

Size	A	B	C	D	E	F	G	H	I	Num of Bolt Holes
2	2.00	3.62	5.00	6.50	0.87	0.75	8.50	14.00	7.87	8
2-½	2.50	4.12	5.88	7.50	1.00	0.875	9.50	18.11	7.87	8
3	3.00	5.00	6.62	8.25	1.12	0.875	11.12	17.10	9.84	8
4	4.02	6.19	7.88	10.00	1.25	0.875	12.00	19.60	9.84	8
6	5.98	8.50	10.62	12.50	1.44	0.875	15.88	25.80	13.78	12
8	8.00	10.62	13.00	15.00	1.62	1.00	16.50	30.80	15.75	12
10	10.00	12.75	15.25	17.50	1.87	1.125	18.00	36.70	17.72	16

ASME Class 300 Flanged  
Cast Steel Gate Valve  
Sharpe® Series 35314

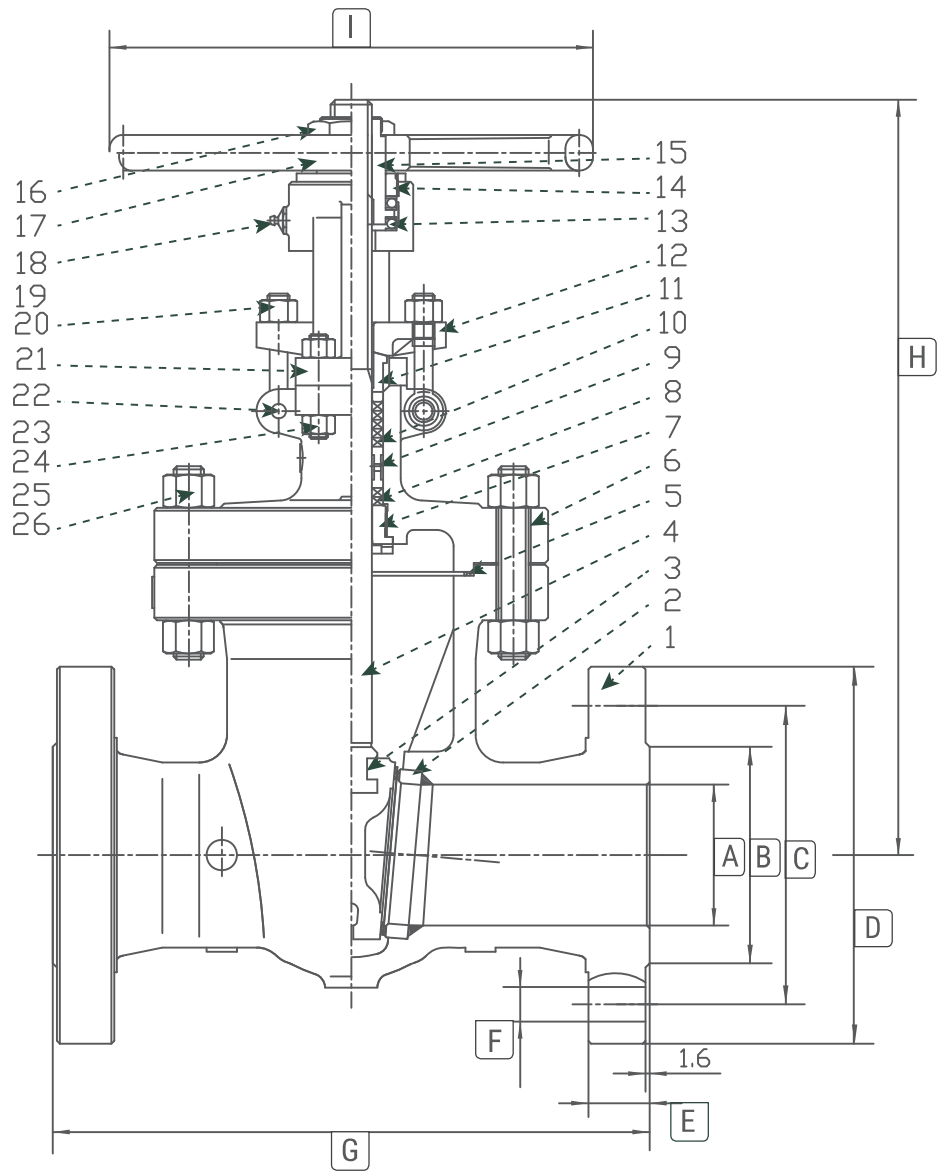

**Parts & Materials** (Sizes 12" – 24")

No.	Part Name	Material
1	Body	Carbon Steel ASTM A216 - WCB
2	Seat	A105 & STL 6
3	Wedge	A216 WCB & ER410
4	Stem	A182 - F6a
5	Gasket	304 Stainless Steel & Graphite
6	Bonnet	Carbon Steel ASTM A216 - WCB
7	Back Seat	410 Stainless Steel
8	Gland Packing	304 Stainless Steel & Graphite
9	Distance Ring	410 Stainless Steel
10	Gland Packing	Flexible Graphite
11	Gland	410 Stainless Steel
12	Gland Flange	Carbon Steel ASTM A216 - WCB
13	Gland Nut	Carbon Steel
14	Stem Nut	A439-D2
15	Lock Nut	Carbon Steel
16	Hand-wheel	Ductile Iron
17	Grease Nipple	Carbon Steel
18	Eye Bolt	2H Steel A194
19	Eye Nut	B7 Steel A193
20	Yoke	Carbon Steel ASTM A216 - WCB
21	Pin	Carbon Steel
22	Bolt	B7 Steel A193
23	Nut	2H Steel A194
24	Bolt	B7 Steel A193
25	Nut	2H Steel A194

**Dimensions** (Inches)

Size	A	B	C	D	E	F	G	H	I	Num of Bolt Holes
12	12.00	15.00	17.75	20.50	2.00	1.25	19.75	56.30	19.70	16
14	13.27	16.25	20.25	23.00	2.12	1.25	30.00	60.70	22.05	20
16	15.24	18.50	22.50	25.50	2.25	1.375	33.00	68.60	25.20	20
18	17.24	21.00	24.75	28.00	2.37	1.375	36.00	82.20	25.20	24
20	19.25	23.00	27.00	30.50	2.50	1.375	39.00	84.70	28.35	24
24	23.17	27.25	32.00	36.00	2.75	1.625	45.00	104.40	35.43	24

ASME Class 300 Flanged  
Cast Steel Gate Valve  
**Sharpe® Series 35314**



## How to order Series 35314

Example:

8		35	-	3	1	4	
Size		Series		Class	Ends	Body Material	Suffixes & Options
2	12	35	-	3 300	1 Flange	4 ASTM A216 Cast WCB Carbon Steel	GO Gear Operator (POA 12" & Smaller)
2-½	14*				2 Butt-weld*		
3	16*						
4	18*						
6	20*						
8	24*						
10	-						

**Notes:**

\*POA.

Responsibility for proper selection, use and maintenance of any product remains solely with the purchaser and end user. We reserve the right to modify or improve the designs or specifications of any product at any time without notice.