



# 70-800 SERIES

## Male NPT Bronze Ball Valve

<b>Job Name:</b>	<b>Contractor:</b>
<b>Job Location:</b>	<b>P.O. Number:</b>
<b>Engineer:</b>	<b>Representative:</b>
<b>Tag:</b>	<b>Wholesale Distributor:</b>

### DESCRIPTION

The Apollo® 70-800 Series is a standard port ball valve that eliminates the need for an extra nipple when connecting to female connections.

### FEATURES

- Adjustable Packing Gland
- Blow-Out Proof Stem Design
- RPTFE Seats and Stuffing Box Ring

### PERFORMANCE RATING

- Maximum Pressure: 600 psi CWP, 150 psi SWP
- Vacuum Service to 29 in. Hg
- Max. Temp (RPTFE): 425 at 100 psig

### STANDARD MATERIALS LIST

Part Name	Standard Material
Lever and Grip	Steel, Zinc Plated w/ Vinyl
Stem Packing	RPTFE
Stem Bearing	RPTFE
Ball	B16 Brass, Chrome Plated
Seat (2)	RPTFE
Retainer	B16 Brass
Gland Nut	B16 Brass
Stem	B16 Brass
Lever Nut	Steel, Zinc Plated
Body Seal (1 1/4" to 1 1/2")	PTFE
Body	B584 Bronze-C84400

### DIMENSIONS

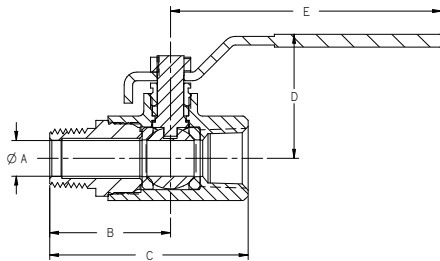

Model Number	Size (in.)	Dimensions					Wt (lbs.)
		A	B	C	D	E	
70-801	1/4"	0.37	1.40	2.43	1.75	3.87	0.63
70-802	3/8"	0.37	1.46	2.50	1.75	3.87	0.60
70-803	1/2"	0.50	1.68	2.81	1.81	3.87	0.72
70-804	3/4"	0.68	2.00	3.50	2.12	4.87	1.42
70-805	1"	0.87	2.31	4.00	2.25	4.87	1.93
70-806	1 1/4"	1.00	2.31	4.31	2.62	5.50	3.19
70-807	1 1/2"	1.25	3.00	5.18	3.06	8.00	4.60

### APPROVALS

- MSS SP-110; Ball Valves, Threaded, Socket-Welding,
- Federal Specifications: WW-V-35C, Type: II,
- CRN: OC10908.5C



### FLOW CAPACITY

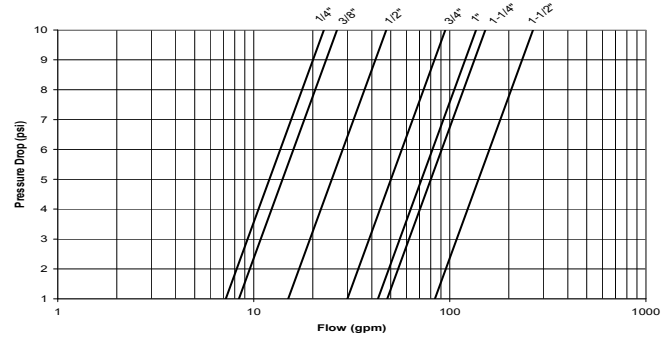

### OPTIONS & SIZES

- |  |                |
|--|----------------|
| <input type="checkbox"/> MPTFE Seats & Packing                         | 1/4" to 1 1/2" |
| <input type="checkbox"/> UHMWPE Seats (Non-PTFE)                       | 1/4" to 1 1/2" |
| <input type="checkbox"/> Stem Grounded                                 | 1/4" to 1 1/2" |
| <input type="checkbox"/> 1 1/4" CS Stem Extension                      | 1/4" to 1 1/2" |
| <input type="checkbox"/> 2 1/4" CS Stem Extension                      | 1/4" to 1 1/2" |
| <input type="checkbox"/> Steel Tee Handle                              | 1/4" to 1 1/2" |
| <input type="checkbox"/> 90° Reversed Stem                             | 1/4" to 1 1/2" |
| <input type="checkbox"/> SS Lever & Nut                                | 1/4" to 1 1/2" |
| <input type="checkbox"/> Side Vented Ball (Uni-Directional)            | 1/4" to 1 1/2" |
| <input type="checkbox"/> Wheel Handle, Steel                           | 1/4" to 1 1/2" |
| <input type="checkbox"/> Chain Lever-Vertical                          | 3/4" to 1 1/2" |
| <input type="checkbox"/> Graphite Packing                              | 1/4" to 1 1/2" |
| <input type="checkbox"/> SS Latch-Lock Lever & Nut                     | 1/4" to 1 1/2" |
| <input type="checkbox"/> Cam-Lock & Grounded                           | 1/4" to 1 1/2" |
| <input type="checkbox"/> SS Tee Handle & Nut                           | 1/4" to 1 1/2" |
| <input type="checkbox"/> VTFE Trim                                     | 1/4" to 1 1/2" |
| <input type="checkbox"/> SS Hi-Rise Locking Wheel Handle, SS Nut       | 1/4" to 1 1/2" |
| <input type="checkbox"/> Cyl-Loc and Grounded                          | 1/4" to 1 1/2" |
| <input type="checkbox"/> Automatic Drain                               | 1/4" to 1 1/2" |
| <input type="checkbox"/> Less Lever & Nut                              | 1/4" to 1 1/2" |
| <input type="checkbox"/> Latch Lock Lever-Lock in Closed Position Only | 1/4" to 1 1/2" |
| <input type="checkbox"/> SS Oval Latch-Lock Handle & Nut               | 1/4" to 1"     |
| <input type="checkbox"/> SS Oval Handle (No Latch) & Nut               | 1/4" to 1 1/2" |
| <input type="checkbox"/> 2 1/4" CS Locking Stem Extension              | 1/4" to 1 1/2" |
| <input type="checkbox"/> Oxygen Cleaned                                | 1/4" to 1 1/2" |
| <input type="checkbox"/> Chain Lever-Horizontal                        | 3/4" to 1 1/2" |
| <input type="checkbox"/> Static Grounded Ball & Stem                   | 1/4" to 1 1/2" |
| <input type="checkbox"/> 250# Steam Trim                               | 1/4" to 1 1/2" |

Conbraco Industries, Inc. 701 Matthews Mint Hill Rd. Matthews NC 28106 USA; [www.apollovalves.com](http://www.apollovalves.com); 704-841-6000

This specification is provided for reference only. Conbraco reserves the right to change any portion of this specification without notice and without incurring obligation to make such changes to Conbraco products previously or subsequently sold.